

Group 1 consists of 10 lots (Lots 5-14) along Valley Circle cul-de-sac which will receive road, water, sewer, and electric and telephone trenching improvements.

Group 2 consists of two lots that will be provided sewer infrastructure. The Group 2 lots already have water, electric, and telephone service. Group 2 and Subgroup 4A1 are comprised of the same lots.

Group 3 consists of 150 lots that will receive water, electric and telephone service, but no sewer service. The Group 3 and Subgroup 4A2 are comprised of the same lots;

Lots 38-41, 72-88, 93-95, 102-117, 120-132, 133A, 135-140, 158, 164, 170-181, 182A, 184-223, 225-239, 242-249, 254, 257, 262-264.

Group 4 consists of 212 lots which will receive road improvements. Group 4 is divided into Subgroups 4A and 4B. Subgroup 4A lots were scheduled to receive road improvements under the Bankruptcy Plan and will receive a share of the Bankruptcy Fund. The Subgroup 4B lots were not scheduled to receive road improvements under the Bankruptcy Plan and will not receive a share of the Bankruptcy Fund. Group 4A is further divided into Subgroup 4A1, 4A2, and 4A3. Subgroup 4A1 corresponds to the lots which also comprise Group 2. Subgroup 4A2 corresponds to the lots which also comprise Group 3. Subgroup 4A3 corresponds to the balance of the Group 4A lots as follows:

Subgroup 2/4A1 - 2 lots - Lots 42,43

Subgroup 3/4A2 - 150 lots - Lots 38-41, 72-88, 102-117, 120-132, 133A, 135-140, 158-164, 170-181, 182A, 184-223, 225-239, 242-249, 254-257, 262-264

Subgroup 4A3 - 28 lots - Lots 36A, 44-48, 89-92, 100, 101, 118, 166, 119, 157, 165-167, 168A, 169, 224, 240, 241, 250-252, 258, 259A

Subgroup 4B - 32 lots - Lots 65RA ( Angel Fire Chalets Unit 4), 96-99, 141-156, 267-275, 281, 282

Note:  
Base mapping and related information furnished by Angel Fire Resort. Existing utility location mapping furnished by the Village of Angel Fire.

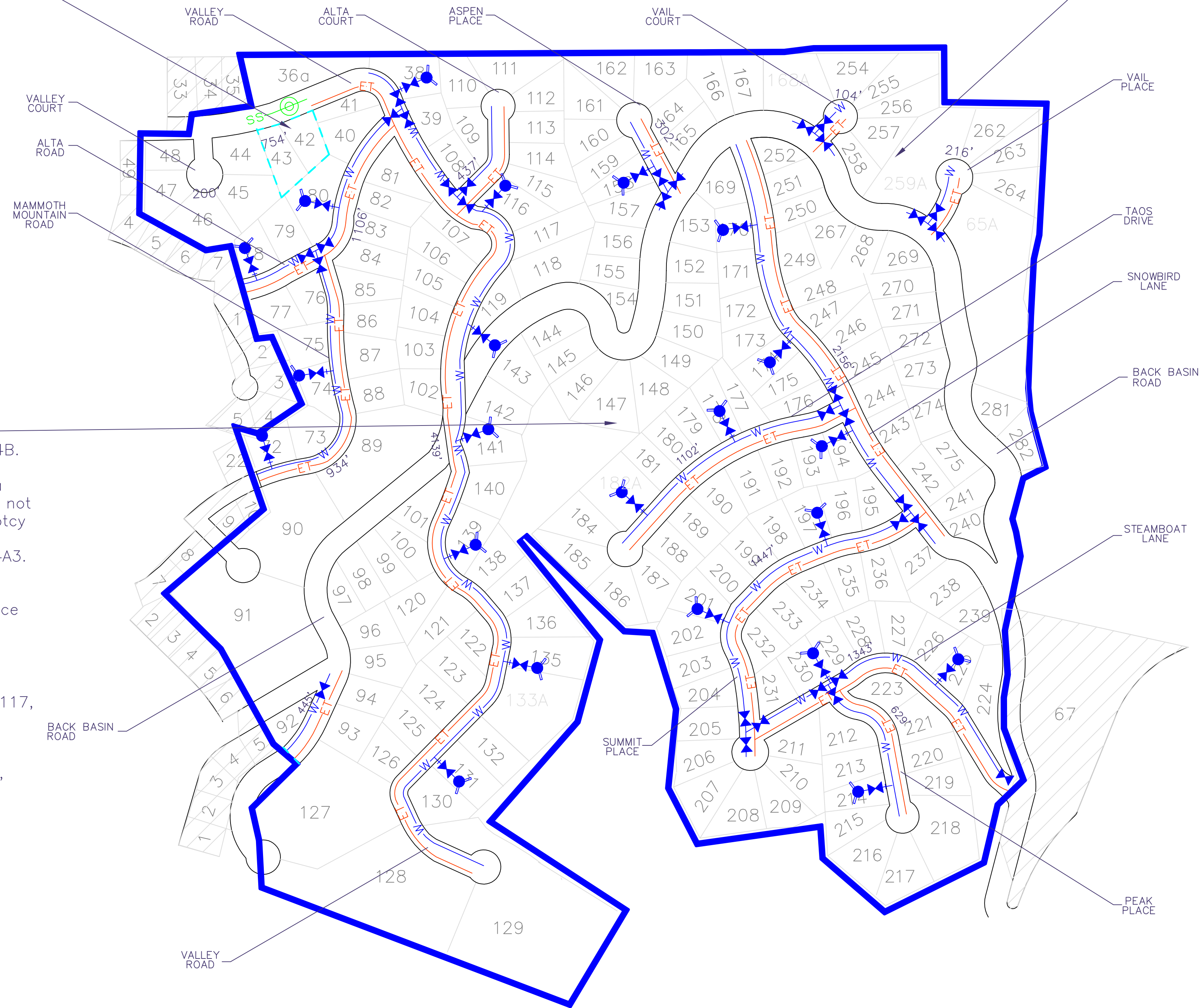
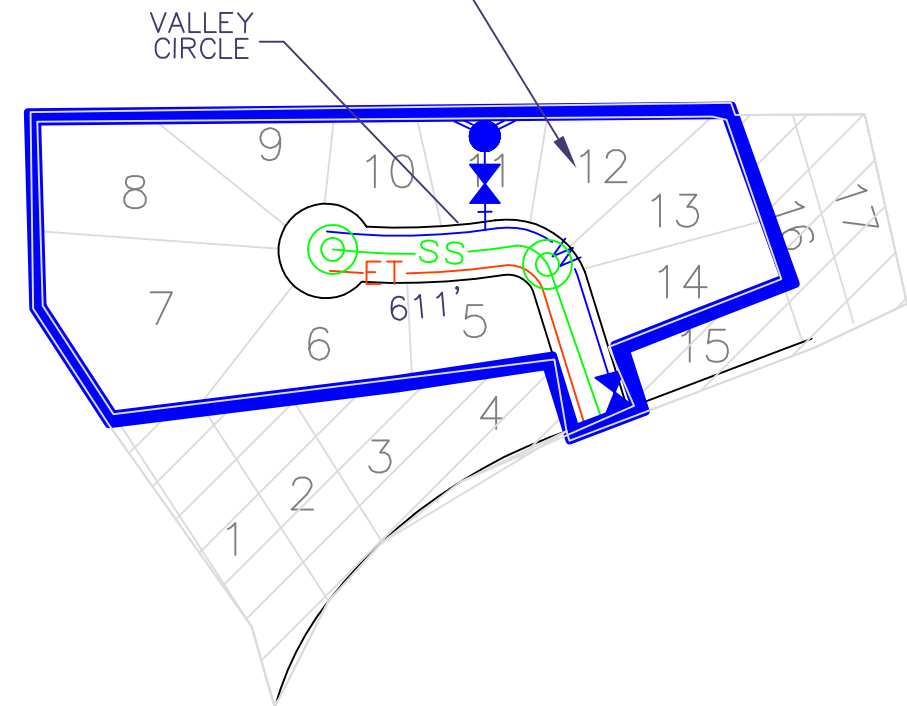

ANGEL FIRE VILLAGE NORTH

SCALE: 1:300

LEGEND

- Proposed Fire Hydrant Assembly
- Proposed Water Line
- Proposed Electrical & Telephone Common Trench
- Proposed Sanitary Sewer Line
- Proposed Sanitary Sewer Manhole
- Proposed Water Valve
- Assesment Boundary

Note : Back Basin Road requires road improvement only except in areas shown otherwise. Group 3 includes all lots except Group 1, 2, & Back Basin road-only lots.

Revised 01/21/08

- 1/12/06 ASSESSMENT BOUNDARY
- 1/19/06 BACK BASIN IMPROVEMENT
- 1/21/08 GROUP 3 REVISED
- 1/21/08 GROUP 2 REVISED
- 1/21/08 GROUP 4 REVISED

ANGEL FIRE VILLAGE NORTH WATER/SANITARY SEWER IMPROVEMENTS

C-006